



Station Terrace, Radcliffe-On-Trent, Nottinghamshire, NG12 2AH

£795 Per month

- Two Bedroom Home
- Village Centre Location
- Reception Room and Conservatory
- Modern Shower Room
- Rear Garden with Access
- Fitted Kitchen
- Available Immediately
- Please Call to View

Reception Room 10'6" x 10'4" (3.20m x 3.15m)

Kitchen 8'2" x 7'7" (2.49m x 2.31m)

Shower Room 7'4" x 5'4" (2.24m x 1.63m)

Master Bedroom 10'6" x 10'4" (3.20m x 3.15m)

Bedroom Two 8'5" x 8' (2.57m x 2.44m)



Spacious two bedroom cottage | Two reception rooms | Fitted kitchen | Mature garden | Three piece shower room | Entrance porch | Available to move into immediately | Please contact Smooth to arrange your visit

Positioned in the desirable village of Radcliffe-on-Trent, this two bedroom home is available from the end of October 2022

It is located on Station Terrace, in the centre of the village, and is within walking distance of all local amenities such as grocery shops, restaurants, pubs and schools. This home offers quiet living and outdoor space along with excellent access to the local transport links.

On offer is a spacious lounge, a fitted kitchen

with dishwasher, a three piece shower room and two bedrooms. Outside you will find a garden with laid lawn and a patio area with a shed and a further two storage units.

Early viewings are advised to avoid disappointment, please contact Smooth to arrange your visit.





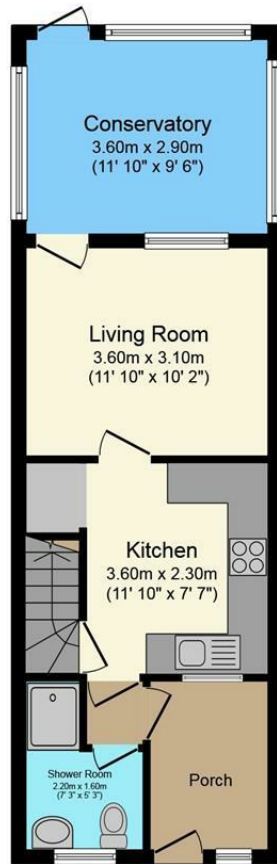

Ground Floor

Floor area 43.4 sq.m. (467 sq.ft.) approx

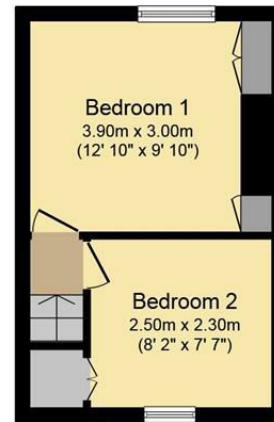

First Floor

Floor area 20.7 sq.m. (223 sq.ft.) approx

Total floor area 64.2 sq.m. (691 sq.ft.) approx

This plan is for illustration purposes only and may not be representative of the property. Plan not to scale.

Powered by audioagent.com

Upper Floor Halford Street, Leicester, Leicestershire, LE1 1JA

T: 03333 448 248

E: hello@smoothonline.co

Agents Note: Whilst every care has been taken to prepare these sales particulars, they are for guidance purposes only. All measurements are approximate and for general guidance purposes only and whilst every care has been taken to ensure their accuracy, they should not be relied upon and potential buyers are advised to recheck the measurements.