



Albion Road, Sileby, Leicestershire, LE12 7RA

Asking price £175,000

Freehold

- Two bedroom home
- Highly popular location
- Enclosed rear garden
- No chain
- Ideal first home or investment
- Two reception room
- Please call to view

Property Description

Dining Room	11'7" x 10'7" (3.53m x 3.23m)
Reception Room	11'5" x 11'7" (3.48m x 3.53m)
Kitchen	8'6" x 5'6" (2.59m x 1.68m)
Master Bedroom	11'7" x 10'7" (3.53m x 3.23m)
Bedroom Two	11'9" x 9'9" (3.58m x 2.97m)
Bathroom	8'6" x 5'6" (2.59m x 1.68m)



Positioned in the centre of Sileby, this spacious two bedroom home would be ideal as a first home or investment. Benefitting from two reception rooms, two double bedrooms, an enclosed rear garden and walking distance to the local amenities. There is no chain with this home, please call to view!

Situated in the highly popular Charnwood village of Sileby, this spacious two bedroom home would prove to be an ideal first home or investment. Benefitting from a dining room, reception room, kitchen and two double bedrooms whilst there is also a three piece bathroom suite and a shared rear garden.

Locally, there is Sileby Redlands Community Primary School which has an Ofsted rating of

GOOD whilst there is also Homefield College also with an Ofsted rating of GOOD. This home is within walking distance of the local shops and cafes whilst the train station is also just 0.16 miles away.

This home is being offered to the market with no upward chain, we strongly advise early internal viewings to avoid missing out on this home. Please contact Smooth to arrange your visit!





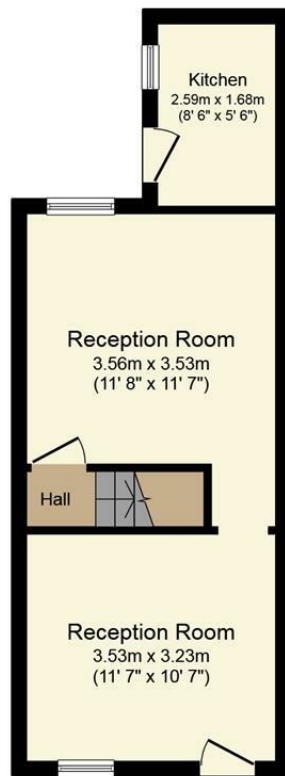

Ground Floor

Floor area 31.9 sq.m. (344 sq.ft.) approx



First Floor

Floor area 31.9 sq.m. (344 sq.ft.) approx

Total floor area 63.9 sq.m. (688 sq.ft.) approx

This plan is for illustration purposes only and may not be representative of the property. Plan not to scale.

Powered by audioagent.com

Upper Floor Halford Street, Leicester, Leicestershire, LE1 1JA

T: 03333 448 248

E: hello@smoothonline.co

Agents Note: Whilst every care has been taken to prepare these sales particulars, they are for guidance purposes only. All measurements are approximate are for general guidance purposes only and whilst every care has been taken to ensure their accuracy, they should not be relied upon and potential buyers are advised to recheck the measurements.